



KONICA MINOLTA

# ENHANCED FUNCTIONS TO MEET YOUR VARIED BUSINESS NEEDS!

A3 Monochrome bizhub 226 Series



**bizhub 226/206**



Giving Shape to Ideas

The enhanced functions on the new bizhub 226 series improve productivity, enhance operability and increase document security.

## OPERABILITY ENHANCED FOR IMPROVED EFFICIENCY

### > Special hard keys

Users can find their commonly use functions on the hard keys eliminating time wastage to search through different menus.



### > Higher productivity

Shorter warm-up time and first copy out time allow higher productivity in the business workplace.

	bizhub 226	bizhub 206
Speed	22 ppm	20 ppm
WUT <sup>*1</sup>	15 sec. or less	
FCOT <sup>*2</sup>	6.5 sec. or less	

<sup>\*1</sup> WUT (Warm Up Time): The time between when the power switch is turned on and when copy operation can start.

<sup>\*2</sup> FCOT (First Copy Out Time): The time between when the Start button is pressed and the end of output of the first copy page.

### > LCD screen



The bizhub 226 series is equipped with a backlit LCD screen. When an error occurs, users do not need to go through the product manual as the LCD screen will display the guidance.

## SECURE

### > SMTP authentication

bizhub 226 series supports SMTP authentication which allows sending e-mail to authenticated users. E-mail servers and ISPs (Internet Service Providers) with SMTP authentication connects to SMTP server that allows SSL communication to send e-mail securely.

Small offices and business owners who do not own a private e-mail server can benefit from this feature.

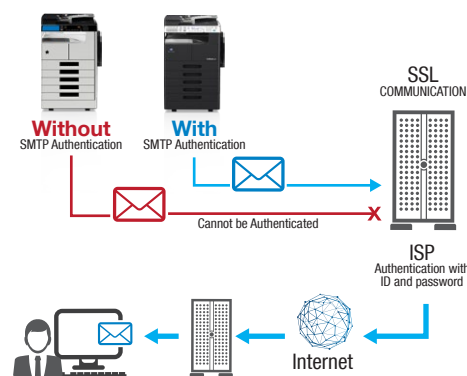

### > Watermark

Users can choose different types of watermarks to differentiate the importance of documents.

### > Security Print

Users can set password in the printer driver before executing the print. The MFP will not release any printout until user enters the correct password on the MFP operation panel. This will prevent any confidential documents being left on the MFP or taken by unauthorised users.



### > Account Track

Usage restriction can be applied to copy operation by registering a 3-digit account number.

# FEATURES TO BOOST ENVIRONMENTAL PERFORMANCE

## > Variety of copy and print features

Konica Minolta's bizhub 226 series offers a variety of copy and print features to meet users' needs.



Users can collate multiple pages into one booklet

\* Optional Auto Duplex Unit AD-509 is required.



Variety of duplex copy methods to fulfill different purposes.

- » 1-sided 2-sided<sup>\*1</sup>: Automatic double-sided copying.
- » 2-sided 1-sided<sup>\*2</sup>: A double-sided document can be copied into 2 pages with 1-sided each.
- » 2-sided 2-sided<sup>\*3</sup>: Automatically copy double-sided document to one sheet of paper.

<sup>\*1</sup> Optional Auto Duplex Unit AD-509 is required.

<sup>\*2</sup> Optional Reverse Automatic Document Feeder DF-625 is required.

<sup>\*3</sup> Optional Auto Duplex unit AD-509 and Reverse Automatic Document Feeder DF-625 are required.

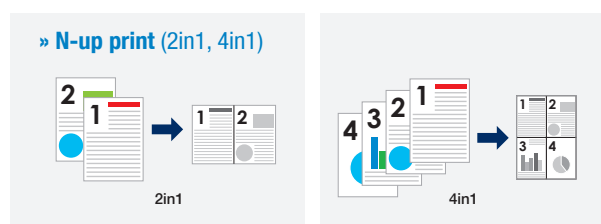

Users have the option to print multi-page documents on one sheet. 2in1 prints 2 pages on 1 side and 4in1 prints 4 pages on 1 side.

## Linux support

Output from a Linux environment is also available.

### [ Supported Linux OS ]

Red Hat Enterprise Linux 5 (CUPS Ver1.2.4) ×86

Red Hat Enterprise Linux 5 (CUPS Ver1.2.4) AMD64/Intel64

SUSE Linux Enterprise Desktop 11(CUPS Ver1.1.23) ×86

SUSE Linux Enterprise Desktop 11(CUPS Ver1.1.23) AMD64/ Intel64

## COLOUR SCAN FEATURES

### > Colour scan

Colour documents can be digitised into colour files at 200pm (150dpi)<sup>\*1</sup>. Users can also choose a suitable file format for the work objective (TIFF, PDF and JPEG).

<sup>\*1</sup> When equipped with the Reverse Automatic Document Feeder DF-625.

### > Multiple destination

Users have the option to save the scanned files directly to USB memory or to different destinations such as email<sup>\*1</sup>, SMB<sup>\*1</sup> or FTP<sup>\*1</sup>.

<sup>\*1</sup> Optional Network Interface Card NC-504 or PCL Controller with NIC IC-209 and Option Panel MK-749 are required.

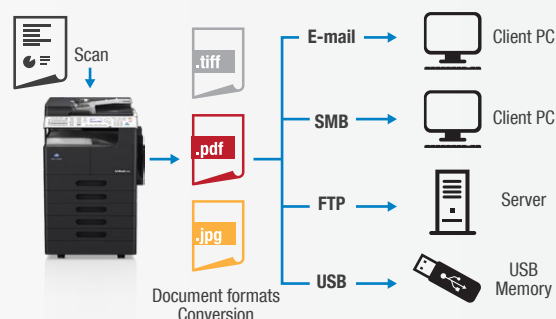

### > ID copy (2-sided document into one sheet)

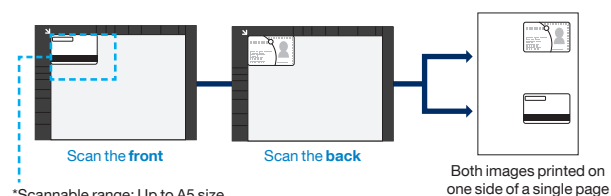

Press the ID copy button to copy any card that has a front and back such as employee ID, driver license, to print both images on one side of the paper. The legible range is up to A5 size<sup>\*1</sup>

<sup>\*1</sup> More than one card can be placed (up to A5), as long as the originals are placed within the platen glass.

# OUTSTANDING ENVIRONMENTAL PERFORMANCE

## › Simitri HD Polymerised Toner

Comparison of CO<sub>2</sub> emissions during the production of Simitri toner and pulverised toner



Konica Minolta's own Polymerised Toner technology achieves high image quality. The toner fuses at low temperature to bring the overall reduction of power consumption and CO<sub>2</sub> emission, and saving TCO. CO<sub>2</sub> emission in the production process can also be greatly reduced, compared to pulverised toner.

## › Toner loop mechanism

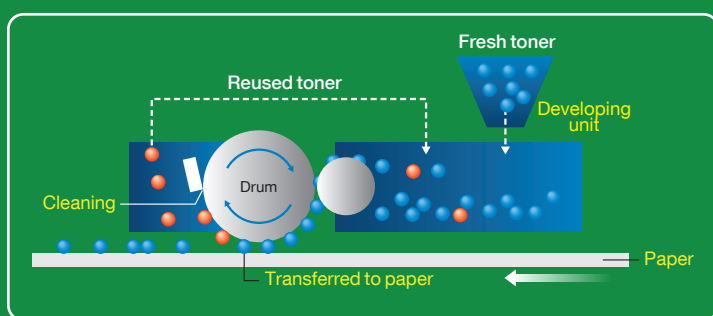

With the Konica Minolta's Toner Loop Mechanism technology, any toner that has not been transferred to the paper will be collected, circulated and reused to eliminate toner wastage.

## › Double-sided print and double-sided scan



2-sided document can be output by the Auto Duplex Unit AD-509 (optional) to reduce paper amount.

Any multiple 2-sided documents can be scanned automatically all at once with the Reverse Automatic Document Feeder DF-625 (Optional). Scan performance (1-sided per minute)

	Black/white binary	Grayscale	Full colour
150dpi	46ppm	38ppm	20ppm
300dpi	46ppm	16ppm	8ppm
600dpi	23ppm	-	-

\* When equipped with the Reverse Automatic Document Feeder DF-625.

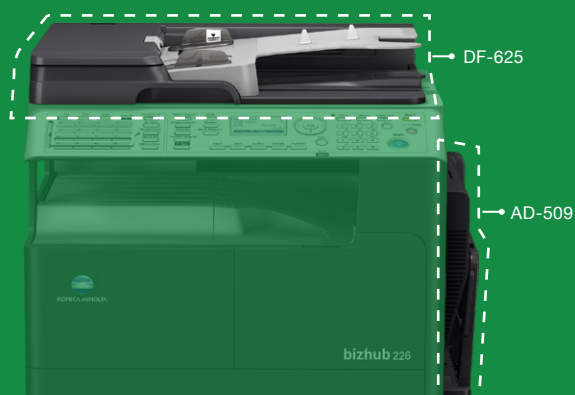



# bizhub 226/206

PRINT SPEED:

**22 / 20 ppm**  
Monochrome

MAX POWER  
CONSUMPTION:

**1300w**

MAX PAPER  
CAPACITY:

**1,350**<sup>\*1</sup> sheets

<sup>\*1</sup> With options attached.

SCANNING SPEED<sup>\*2</sup> <sup>\*3</sup>:

**20 / 46 opm**  
Colour / Monochrome

<sup>\*2</sup> When using the Reverse Automatic Document Feeder DF-625.

<sup>\*3</sup> Option Card IC-209 or NC-504 and Option Panel MK-749 are required.

SCAN RESOLUTION:

up to  
**600x600 dpi**

PRINT RESOLUTION:

**600x600 dpi**



## Key Features:

Booklet print to collate multiple pages into one booklet<sup>\*4</sup> and variety of duplex copy methods to fulfil different purposes.

<sup>\*4</sup> Optional Auto Duplex Unit AD-509 is required.

To output 2-sided document into one sheet. Example: ID Copy.

Multiple convenience colour scan features.

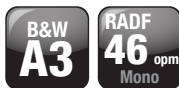

<sup>\*1</sup> Optional  
<sup>\*2</sup> 150 dpi

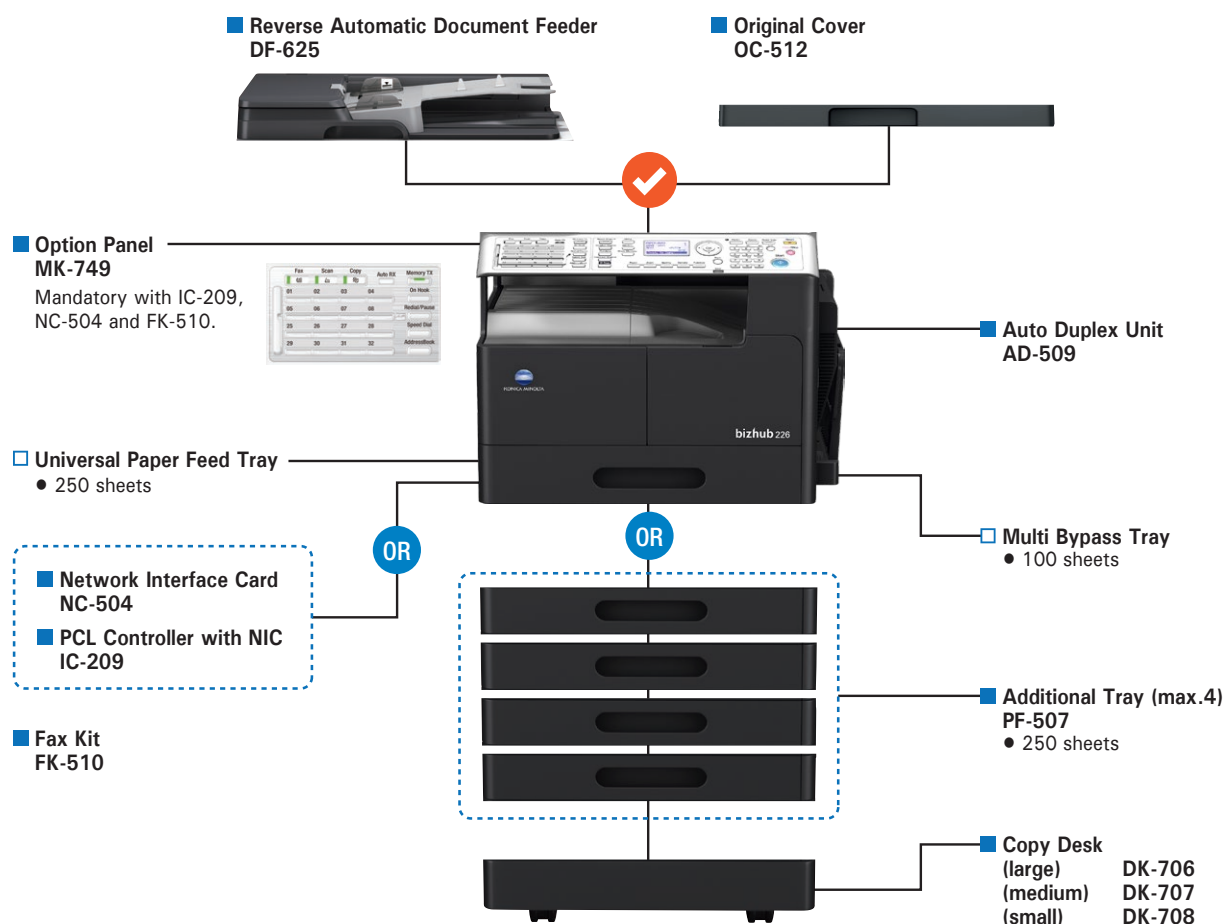

OR

One of the options may be selected (not mandatory).



One of the options must be selected (mandatory).

■ Optional  
□ Standard

## SPACE REQUIREMENTS - bizhub 226/206

Dimensions (unit: mm)

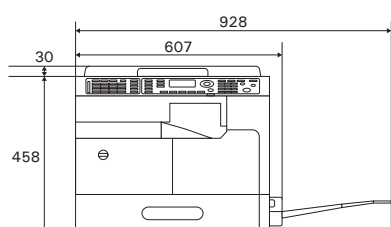

bizhub 226 (206) + OC-512

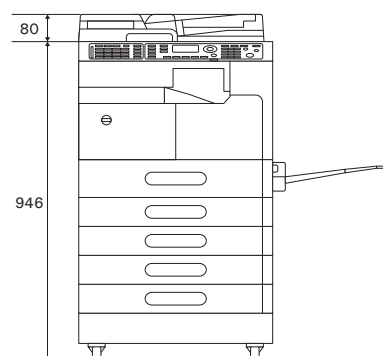
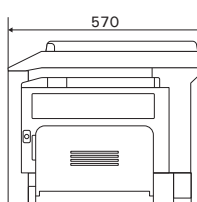

bizhub 226 (206) + DF-625 + PF-507 + DK-708

SPECIFICATIONS - bizhub 226/206

bizhub 226/206 General Specifications

Type	Desktop Printer / Copier / Scanner	
Copy resolution	Scan	Main: 600 dpi x Sub: 600 dpi
	Print	Main: 600 dpi x Sub: 600 dpi
Gradation	256	
Memory size	128 MB (standard)	
Original type	Sheet, book, three-dimensional objects (max. 2 kg)	
Max. original size	A3 or 11" x 17"	
Output size	Main unit (Universal paper feed tray): Width: 90 mm to 297 mm (A3), Length: 139.5 mm (5.5") to 431.8 mm (17") Multi Bypass Tray (MB-505): Width: 90 mm to 297 mm (A3), Length: 139.5 mm (5.5") to 431.8 mm (17") Additional Tray (PF-507): Width: 182 mm (B5) to 297 mm (A3), Length: 182 mm (B5) to 431.8 mm (17")	
Image loss	4 mm at each edge (top/bottom/right/left edge)	
Warm-Up Time *1 (23 C, std. voltage)	15 sec. or less	
First Copy Out Time *2	6.5 sec. or less	
Copy speed (A4/Letter crosswise)	Simplex	bizhub 226: 22 ppm, bizhub 206: 20 ppm
	Duplex	bizhub 226: 15.8 ppm, bizhub 206: 15.2 ppm
Copy magnification	Fixed ratio	Metric 0.25/0.50/0.70/0.81/1.00/1.15/1.41/2.00/4.00
		Inch 0.25/0.50/0.64/0.78/1.00/1.21/1.29/2.00/4.00
	Zoom ratio set by Up/Down key	25% to 400% Adjustable in 0.01 steps
Paper capacity (64 g/m²)	Main unit (Universal paper feed tray): 250 sheets (up to A3) Multi Bypass Tray: 100 sheets (up to A3) Additional Tray (PF-507) : 250 sheets (up to A3)	
Max. paper capacity (64 g/m²)	1,350 sheets	
Paper weight	Main unit/ Multi Bypass Tray	64 g/m² - 157 g/m²
	Additional Tray (PF-507)	64 g/m² - 90 g/m²
Multi copy setting	1-999 pages	
Max. power consumption	1,300 W (127 V only: 1,350 W)	
Dimensions [W] x [D] x [H]	607 x 570 x 458 mm	
Weight	Approx. 28.2 kg (excluding TC/Developer)	
Space requirements [W] x [D]	Standard configuration: 570 x 570 mm With bypass tray extended: 928 x 570 mm Max. required space incl. maintenance space: 999 x 971 mm*  * When Multi Bypass Tray extended * When Paper Feed Tray pulled out, (Slide length: 397 mm)	
Application software	PageScope Net Care Device Manager & Plug-in LSU (Local Setting Utility)	

\*1 The time required to start printing when then main power switch is turned from OFF to ON.

\*2 A4 long edge feed full size/using the first tray/scanning from the original glass surface.

Printer Functions (Standard: GDI Image Controller)

Type	Embedded	
Print Speed	A4	bizhub 226: 22 ppm, bizhub 206: 20 ppm
	Letter	bizhub 226: 21 ppm, bizhub 206: 19 ppm
Resolution	Main: 600 dpi x Sub: 600 dpi	
Supported OS	Server	Windows Server 2008*/ 2008 R2 ( 64 )/2012 ( 64 ) / 2012 R2 ( 64 ) * Supports the 32-bit ( 86 ) or 64-bit ( 64 ) environment.
	Client	Windows Vista* / 7* / 8* / 8.1* * Support the 32-bit ( 86 ) or 64-bit ( 64 ) environment. Red Hat Enterprise Linux 5 (CUPS Ver1.2.4) 86 Red Hat Enterprise Linux 5 (CUPS Ver1.2.4) AMD64/Intel64 SUSE Linux Enterprise Desktop 11(CUPS Ver1.1.23) 86 SUSE Linux Enterprise Desktop 11(CUPS Ver1.1.23) AMD64/ Intel64
Interface	Standard: USB2.0	
	Ethernet 10Base-T/100Base-TX (Option card: NC-504)	
Protocols	TCP/IP (with Network Interface Card NC-504)	

Printer Functions (Optional: PCL Controller with NIC)

\*Option Panel MK-749 is required.

Type	PCL Controller incl. network interface card	
Print Speed	A4	bizhub 226: 22 ppm, bizhub 206: 20 ppm
	Letter	bizhub 226: 21 ppm, bizhub 206: 19 ppm
Resolution	Main: 1,200 dpi (equivalent) or 600 dpi x Sub: 600 dpi	
Page description language	PCL6/5e	
Supported OS	Server	Windows Server 2008*/ 2008 R2 ( 64 )/2012 ( 64 ) / 2012 R2 ( 64 ) * Supports the 32-bit ( 86 ) or 64-bit ( 64 ) environment.
	Client	Windows Vista* / 7* / 8* / 8.1* * Support the 32-bit ( 86 ) or 64-bit ( 64 ) environment. Red Hat Enterprise Linux 5 (CUPS Ver1.2.4) 86 Red Hat Enterprise Linux 5 (CUPS Ver1.2.4) AMD64/Intel64 SUSE Linux Enterprise Desktop 11(CUPS Ver1.1.23) 86 SUSE Linux Enterprise Desktop 11(CUPS Ver1.1.23) AMD64/ Intel64
Interface	Standard: USB2.0	
	Ethernet 10Base-T/100Base-TX	
Protocols	TCP/IP	

Scanner Functions

Type	Full-Colour scanner	
Scanning size	Standard: Max. A3 or 11" x 17" DF-625 (Optional ADF): Max. A3 or 11" x 17"	
Interface	Ethernet 10Base-T/100Base-TX (Option card: IC-209 or NC-504) USB2.0 (Standard) USB2.0 Host	
Driver	TWAIN driver	
Scanning speed (A4, Simplex) *1	TWAIN	B/W: 26 opm, Grayscale: 23 opm, Colour: 16 opm (150 dpi) B/W: 25 opm, Grayscale: 21 opm, Colour: 7 opm (300 dpi) B/W: 15 opm (600 dpi)
	Network scan *2	B/W: 46 opm, Grayscale: 38 opm, Colour: 20 opm (150 dpi) B/W: 46 opm, Grayscale: 16 opm, Colour: 8 opm (300 dpi) B/W: 23 opm (600 dpi)
Scanning size	Max. A3 or 11" x 17"	
Main function	TWAIN	Real time mode (Scan)
	Network scan *2	Scan to FTP, Scan to PC (SMB), Scan to e-mail, Network TWAIN
Data format	TIFF, PDF, JPEG	

\*1 When using the Reverse Automatic Document Feeder DF-625.

\*2 Option Card IC-209 or NC-504 and Option Panel MK-749 are required.

Fax Functions (Optional)

\*Option Panel MK-749 is required.

Fax Kit	FK-510
Communication	G3
Modem speed	2.4 kbps - 33.6 kbps
Compression	MH, MR, MMR, JBIG
Transmission speed	Approx. 3 sec. (A4, V34, 33.6 kbps, JBIG)
Sending paper size	Scanner: Max. A3 Optional DF-625: Max. (W x L) 297 x 1,000 mm
Recording paper size	Max. A3 (Max 1,000 mm, printed according page partition setting)
Line density	8 dot/mm x 3.85 line/mm, 8 dot/mm x 7.7 line/mm 8 dot/mm x 15.4 line/mm, 16 dot/mm x 15.4 line/mm
Number of Abbreviated.Dial	250
Number of One Touch.Dial	32
Number of Program dials	4
Sequential multiple station transmission	Max. 255
Driver	PC-FAX driver

Reverse Automatic Document Feeder (Optional)

Applied models	DF-625
Type	Circulatory duplex system
Support paper size	Max. A3 or 11" x 17" (Fax mode: Max. 1,000 mm)
Mixed size	Support
Support paper weight	35 to 128 g/m² (Simplex), 50 to 128 g/m² (Duplex, Mixed Original)
Paper capacity	Max. 70 sheets (80 g/m²)
Productivity (A4 portrait, Simplex) *At copy	bizhub 226: 22 ppm, bizhub 206: 20 ppm
Power requirements	Supplied from the MFP main body
Dimensions [W] x [D] x [H]	546 x 486 x 80 mm
Weight	5.3 kg





FOR THE EARTH. FOR THE FUTURE.

**KONICA MINOLTA BUSINESS SOLUTIONS (M) SDN BHD (72640-P)**

Infinite Centre, Lot 1, Jalan 13/6, 46200 Petaling Jaya, Selangor, Malaysia.

Contact Us:

Sales & Marketing:

Tel : +603-7801 2611/ 7966 1000

Fax: +603-7954 8316

Email : [marketing.1@konicaminolta.com](mailto:marketing.1@konicaminolta.com)

Technical Support:

National Service Contact Center: 1-300-Call-KM (2255-56)

[www.konicaminolta.com.my/business](http://www.konicaminolta.com.my/business)